

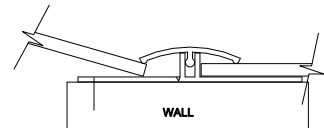

**Product Range:** K-PANEL 2.5mm  
**Drawing Title:** Typical Fixing Details 1/2  
**Drawing Number:** HYG0009 **Rev:** 00  
**Drawing Scale:** 1:1/1:2 when printed at A4  
**Drawing Issue Date:** 30th July 2011

K-PANEL 2.5mm PVC SHEET. (2mm SHEET IS AVAILABLE FOR SUPPLY ONLY).  
 1.22m wide x 2.44m OR 3.048m high

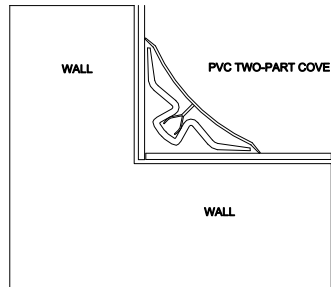

VERTICAL FIXING SINGLE 1:1



MECHANICALLY FIXED BED  
ON A BEAD OF SILICONE.

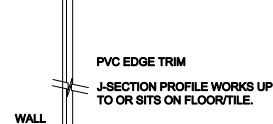

WALL

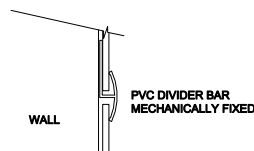

WALL TO FLOOR DETAIL 1:2

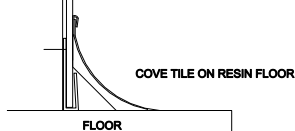

WALL TO FLOOR DETAIL 1:2

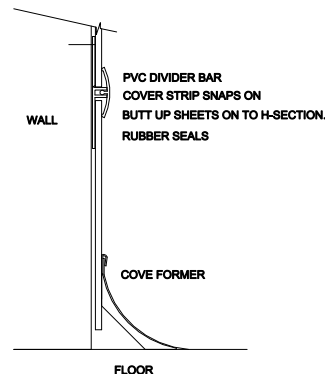

WALL TO FLOOR DETAIL 1:2

## NOTES

K-PANEL 2.5mm SHEET NEEDS A PLUM AND FLUSH WALL FINISH TO ACHIEVE A UNIFORM FINISH, ANY LUMPS AND BUMPS IN THE WALL WILL SHOW ANY UNDULATION AND THE SHEET WILL FOLLOW THIS. TO ACHIEVE A SMOOTH FINISH WITH THIS PRODUCT WHEN USED ON A REFURBISHMENT APPLICATION, LINING THE WALL IN PLASTERBOARD OR PLYWOOD WILL GIVE A SMOOTH AND EVEN FINISH TO APPLY THE K-PANEL. AN ALTERNATIVE TO THE 2.5mm K-PANEL IS THE H-PANEL WHICH IS A 10mm THICK SHEET (HYG0011 & HYG0012).

THE SHEETS COME IN 5 STANDARD COLOURS; WHITE, GREY, PASTEL GREEN, IVORY AND PASTEL BLUE, HOWEVER IF YOU ARE LOOKING FOR A BESPOKE SOLUTION VINYL PRINTING IS AVAILABLE AT AN EXTRA COST. CONTACT OUR TECHNICAL TEAM FOR MORE INFORMATION.

CLEANING STRATEGY FOR O&M MANUALS SEE CSO&M DATA SHEET.

NBS Ref: K13/160

© Copyright 2011 Hygienik Systems Ltd  
 Hygienik Systems Ltd, Unit 3a, A1 Business Park,  
 370 Bradford Road, Brighouse, West Yorkshire, HD6 4DJ

For Further Technical Advice:  
 Telephone: 01274 355777  
 Email: matt@hygienee.com  
 www.hygienee.com



**Product Range:** K-PANEL 2.5mm  
**Drawing Title:** Typical Fixing Details 2/2  
**Drawing Number:** HYG00010 **Rev:** 00  
**Drawing Scale:** 1:2 when printed at A4  
**Drawing Issue Date:** 30th July 2011

K-PANEL 2.5mm PVC SHEET. (2mm SHEET IS AVAILABLE FOR SUPPLY ONLY).

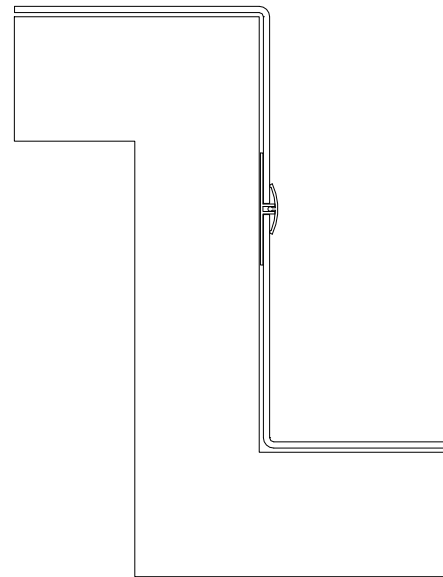

INTERNAL AND EXTERNAL  
PRE-FORMED ANGLES 1:2

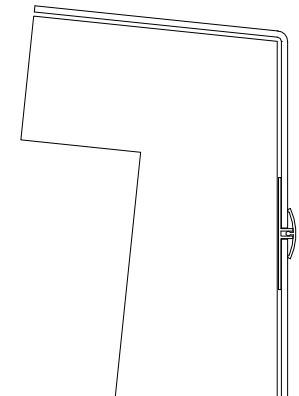

THERMOFORMED CORNERS  
FOR NONE-RIGHT ANGLED  
CORNERS 1:2

## NOTES

THE K-PANEL SHEET IS BONDED WITH HYGIENIK'S POLYMER BONDING, NEEDING ONE APPLICATION ONLY. AN ALTERNATIVE TO POLYMER BONDING IS TO WELD THE JOINTS AND USE 2 PART BONDING AS AN ALTERNATIVE. SEE NBS SPECIFICATION FOR ALTERNATIVES. THE K-PANEL SHEET HAS A CLASS 1 SURFACE SPREAD OF FLAME, HOWEVER WHEN FIXED TO A NONE COMBUSTIBLE SURFACE THIS CAN ACHIEVE A CLASS 0 SURFACE SPREAD OF FLAME. THE K-PANEL IS OFTEN USED AS A SPLASH BACK FOR SINKS. MACHINE EDGE THE 2.5mm SHEET AND STICK TO WALL FOR AN EASY TO KEEP CLEAN SOLUTION.

CLEANING STRATEGY FOR O&M MANUALS SEE CSO&M DATA SHEET.

NBS Ref: K13/160

© Copyright 2011 Hygienik Systems Ltd  
 Hygienik Systems Ltd, Unit 3a, A1 Business Park,  
 370 Bradford Road, Brighouse, West Yorkshire, HD6 4DJ

For Further Technical Advice:  
 Telephone: 01274 355777  
 Email: matt@hygienee.com  
 www.hygienee.com